

*Presenting*

# Artho - Touch™

(Ketoprofen I.P. 20 mg)

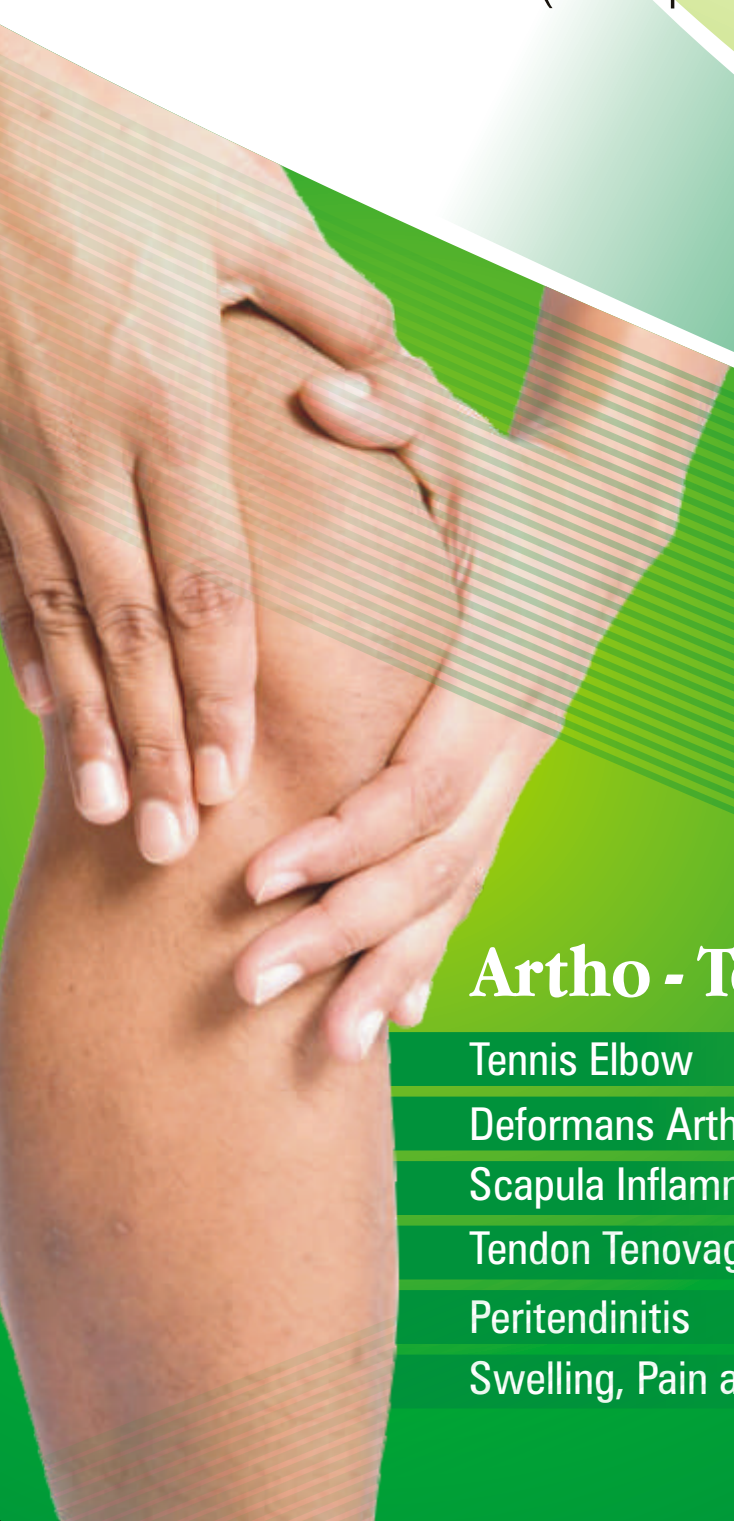

## Artho - Touch™ For

- Tennis Elbow
- Deformans Arthritis
- Scapula Inflammation
- Tendon Tenovaginitis
- Peritendinitis
- Swelling, Pain after Trauma

### How to Apply Artho - Touch™

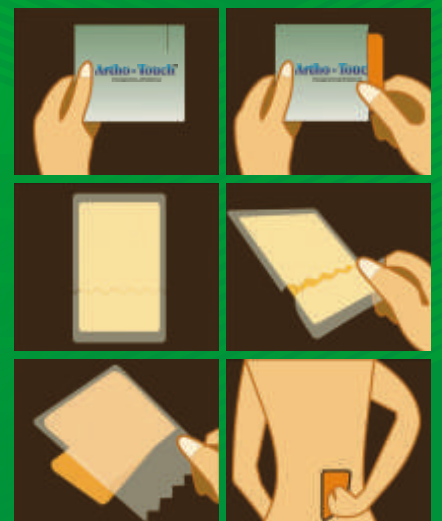

# Wellness and Healthcare Via Transdermal Drug Delivery Systems

## Advantages of **Artho - Touch™**

- Reduction of systemic side effect
- No first pass effect-Low dosage unit works efficiently
- Long lasting application
- No gastric irritation
- Good adhesion to the skin
- Flexibility due to elastic fabric backing
- Patient compliance



## Easy to Apply and Long Lasting

### PRECAUTIONS

- Apply patch immediately after taking out from the pouch
- Close the pouch after removal of the patch
- Protect from light
- Keep out of reach of children
- Apply patch to non hairy part on the body
- Apply patch once a day
- Avoid sun light exposure to the applied site



 **Sparsha Pharma International Pvt. Ltd.**  
(An Indo Japanese Collaboration Company in Pain Management)

Plant : Sy. no. 354, Muppireddy Pally,  
Toopran Mandal - 502 334, Medak District, Andhra Pradesh.

Office : H. No. 8-2-326/5, Road No.3, 3rd Floor  
Banjara Hills, Hyderabad - 500 034, Andhra Pradesh.

Phone : 040-23352581/83 Fax : 040-23352580  
email : info@sparsha.com / marketing@sparsha.com

[www.sparsha.com](http://www.sparsha.com)